

## P/N 0E821801/1000

Hose reel with hydraulic motorization in painted steel s.  
700, for air-water and diesel, 20 bar, without hose.  
Drum width 270 mm. Inlet-outlet G 1" (f)

### SECTORS OF USE

Industry, Mining, Lube trucks and transports

### FEATURES

|                   |                              |
|-------------------|------------------------------|
| Pressure          | 20 bar                       |
| Compatible fluids | air - water - diesel fuel    |
| Swivel joint      | aluminum                     |
| Seals             | Viton®                       |
| Characteristic    | hydraulic                    |
| Material          | painted steel                |
| Couplings         | -                            |
| Hose              | -                            |
| Ø e hose length   | -                            |
| Inlet             | G 1" (f)                     |
| Outlet            | G 1" (f)                     |
| Reel flow path    | aluminum - zinc plated steel |



### OVERALL DIMENSIONS (mm)

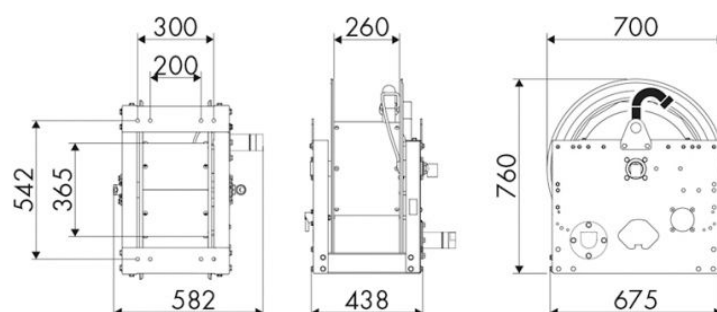

### FURTHER FEATURES

| Capacity 3/8" | Capacity 1/2" | Capacity 3/4" | Capacity 1" | Capacity 1.1/4" | Capacity 1.1/2" | Capacity 2" |
|---------------|---------------|---------------|-------------|-----------------|-----------------|-------------|
| 160 m         | 110 m         | 65 m          | 32 m        | 20 m            | 17 m            | 10 m        |