

## P/N 618/400

Hose reel with pneumatic motorisation s. 618 for oil and similar, 150 bar, without hose. Inlet-outlet G 1" (f)

### SECTORS OF USE

Industry, Mining, Lube trucks and transports

### FEATURES

Pressure	150 bar
Compatible fluids	oils and similar products
Swivel joint	zinc plated steel
Seals	polyurethane
Characteristic	pneumatic
Material	painted steel
Couplings	-
Hose	-
Ø e hose length	-
Inlet	G 1" (f)
Outlet	G 1" (f)
Reel flow path	zinc plated steel



### OVERALL DIMENSIONS (mm)

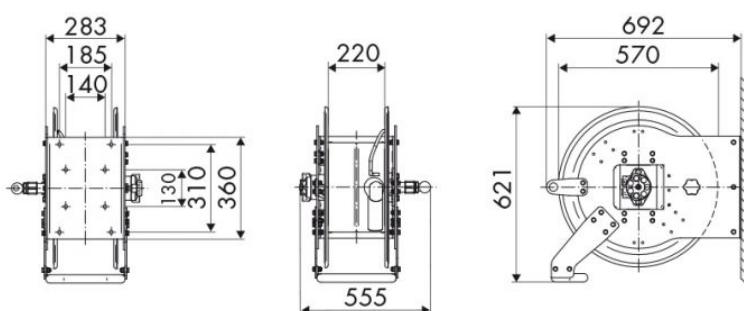

### FURTHER FEATURES

Capacity 3/8"	Capacity 1/2"	Capacity 5/8"	Capacity 3/4"	Capacity 1"
90 m	65 m	45 m	30 m	20 m